

PANEL CUT-OUT

产品类型特性

- 1. AC插座 材质
- 2. 塑胶件 PA66
- 3. 插销黄铜镀镍
- 4. 端子黄铜镀锡
- 1. 使用温度范围: $-10^{\circ}\text{C} \pm 70^{\circ}\text{C}$
- 2. 额定值: 10A/15A AC 125V 250AC
- 3. 绝缘电阻: $100\text{M}\Omega$
- 4. 耐电压: 2500V AC
- 5. 接触电阻: $30\text{M}\Omega$
- 6. 寿命: 5000次
- 结构特性 插拔力: $13.6\text{N} \sim 68\text{N}$
- 端子强度: 60N
- 盐雾测试: $35 \pm 2^{\circ}\text{C}$ 24/h
- 耐环境性能 耐寒性能 $-20 \pm 2^{\circ}\text{C}$ 96/h
- 耐热性能 $100 \pm 2^{\circ}\text{C}$ 96/h
- 耐湿性能 $40 \pm 2^{\circ}\text{C}$ 相对湿度90~95% 96/h



東莞市高迪電子有限公司
DONG GUAN GAO DI ELECTRONICS CO., LTD

TOLERANCE UNLESS OTHERWISE STATED:

Up to 5 ± 0.2
Above 5 ~ 15 ± 0.3
Above 15 ~ 30 ± 0.4
Above 30 ~ 50 ± 0.5
Angle $\pm 0.3^{\circ}$

3RD. ANGEL'S

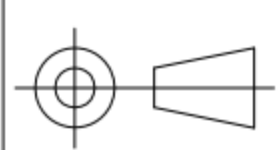

UNITS MM

DRAWN BY:	DATE
Ming Ming Zou	10/31/13
CHECKED BY:	DATE
Ning Ning Su	10/31/13
APPROVED BY:	DATE
Jia Xiang	10/31/13

MAT'L	TITLE	SWITCH
FINISH	MODLE	AC POWER SOCKET
SCALE	DWG NO.	GD-DB-B-M4-W
SHEET NO.	PART NO.	
1 of 1		

SIZE
A4
VER
R